

Mirror Mounts

MNI



The **MNI** mount is a very compact mirror mount which is ideal for application with low space. It can be used for optics up to one inch.

Features:

- Small stable mirror mount
- Open or closed back plate
- Different front plates available
- M4 thread
- #8-32 thread available on request

Screw Options:

- Fine thread screws Model 1:
with **150 $\mu\text{m}/\text{turn}$ (170 TPI)**
with **100 $\mu\text{m}/\text{turn}$ (250 TPI)**

- Micrometer screws:

500 $\mu\text{m}/\text{turn}$ (50 TPI)
250 $\mu\text{m}/\text{turn}$ (100 TPI)
100 $\mu\text{m}/\text{turn}$ (250 TPI)

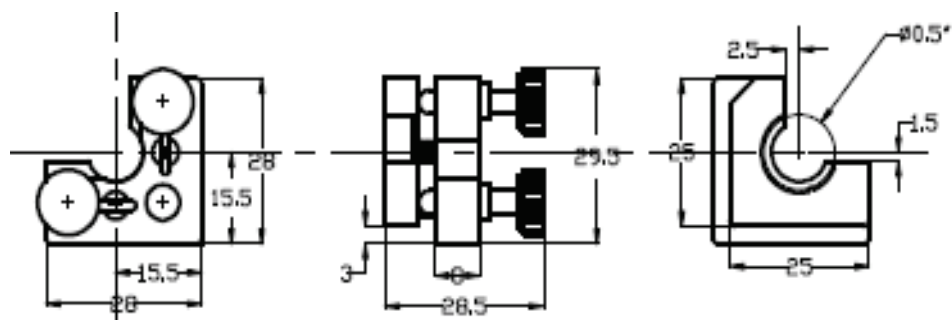







Mirror Mounts

Back plates

			
MNI-2-...	MNI-3-...	MNI-2G-...	MNI-3G-...

Front plates

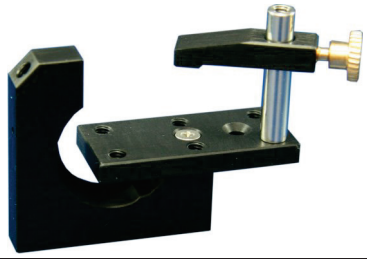
				
...-3000	...-3010 (6H7)	...-3021 (1/2")	...-3030 (1/2")	...-3025 (1")
				
...-3035Up	...-3035Down	Prism Holder ...-3030PH		

The order number of the desired MNI mirror mount consists of the number of the back plate including the quantity of the screws and the number of the chosen front plate.

100 $\mu\text{m}/\text{turn}$ (250 TPI) fine thread screws

